

Valve Cavity
C-16-3

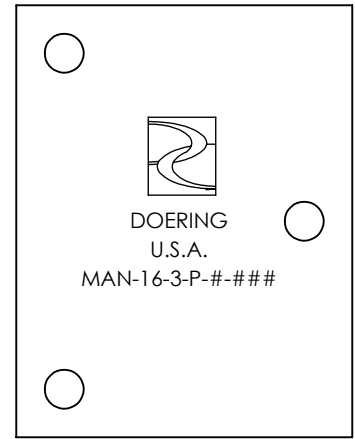
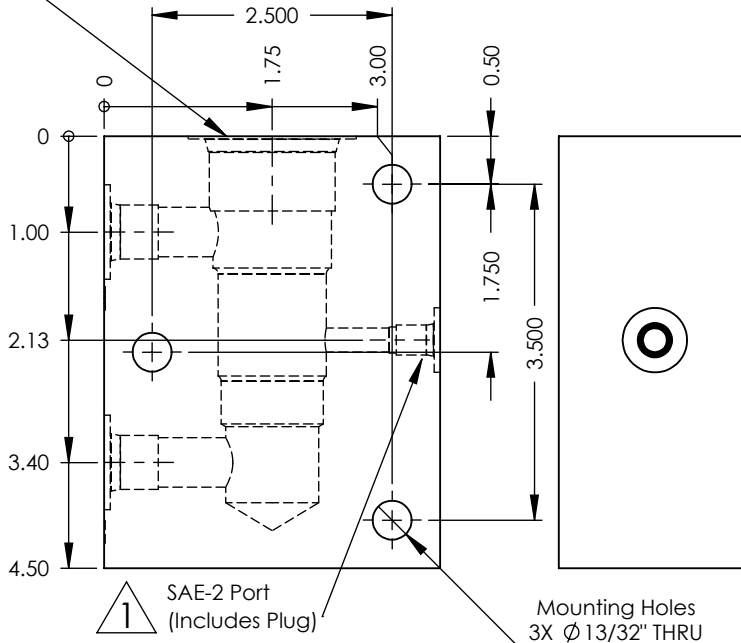
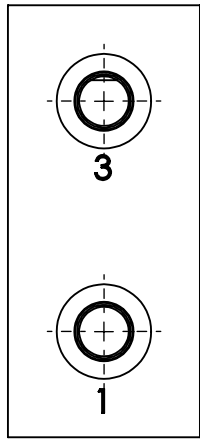
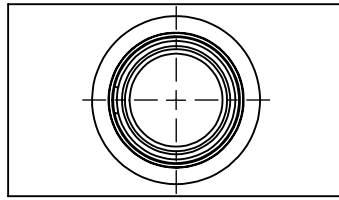
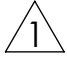

 Remove plug during pump installation

Order Information:

MAN-16-3-P- **-** **-**

Ports 1, 3

- 1 (1/8 NPT)
- 2 (1/4 NPT)
- 3 (3/8 NPT)
- 5 (1/2 NPT)
- 4 (SAE 4 ORB)
- G4 (G 1/4-19 BSPP)
- 6 (SAE 6 ORB)
- G6 (G 3/8-19 BSPP)
- 8 (SAE 8 ORB)

Material Option, Pressure Rating

Blank	(6061 Aluminum)	3,000 PSIG
S	(304 Stainless)	6,500 PSIG
S316	(316 Stainless)	6,500 PSIG